

Promethean Web Apps

Getting started:

1. Go to one.prometheanworld.com
2. Sign into your Promethean account with your Google, Microsoft, or other email.
3. Access the Promethean Web Apps by going to  in the upper left corner of the browser window.

Annotate

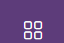
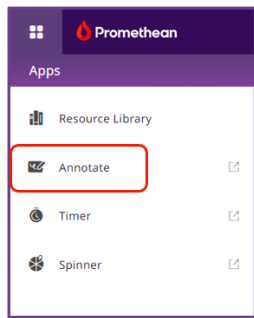

Click on Select screen to choose the screen/window you want to annotate on.

Click to install to desktop

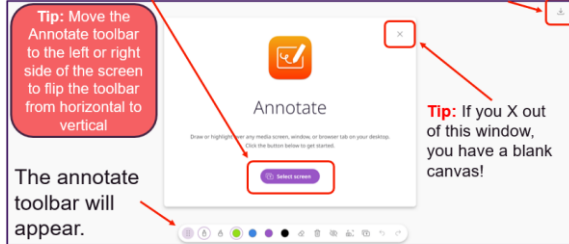

Note: After selecting the window/tab, navigate back to the Chrome tab to begin annotating.

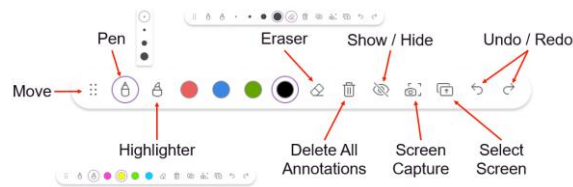

Timer

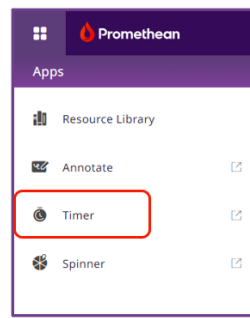

Click to install to desktop

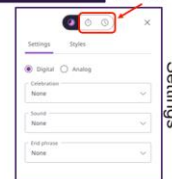
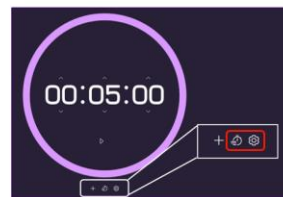
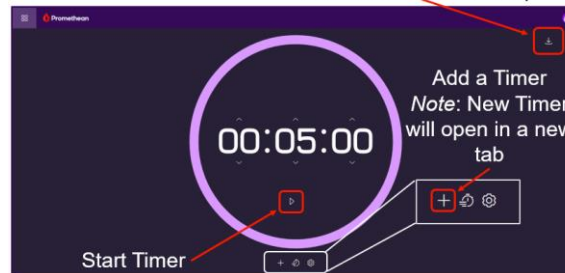

Spinner

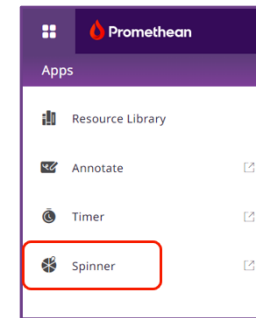

Click to install to desktop

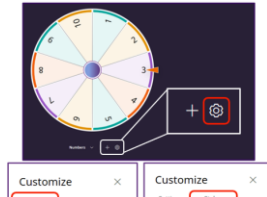
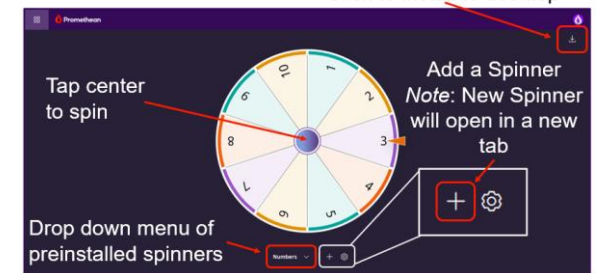

1. Title your Spinner
2. Begin entering items
 - Copy and paste from a list
 - Type each item and hit Enter to go to the next item
3. Click **Done**

