

Disable random MAC address for Wi-Fi connection

Learn how to disable randomisation of MAC address for Wi-Fi connection.



By default, your ActivPanel's Wi-Fi connection is set to utilize a randomized MAC address for Wi-Fi, for increased privacy and security.

In case this is not supported by your network infrastructure, you can easily set the Activpanel to use the device MAC address instead, following these steps:

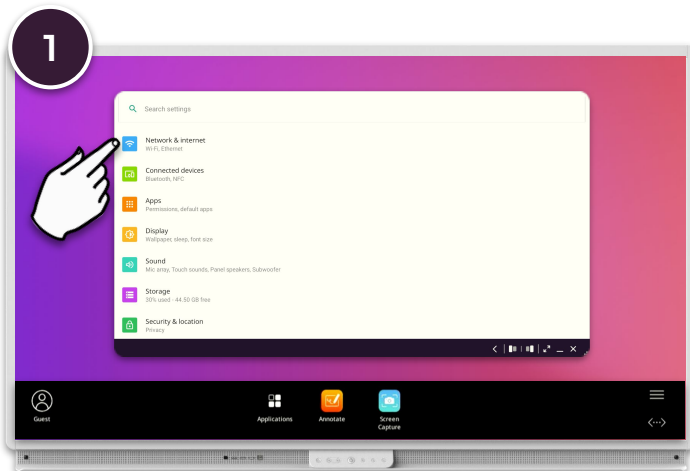

Open **Settings** and select **Network & Internet**.

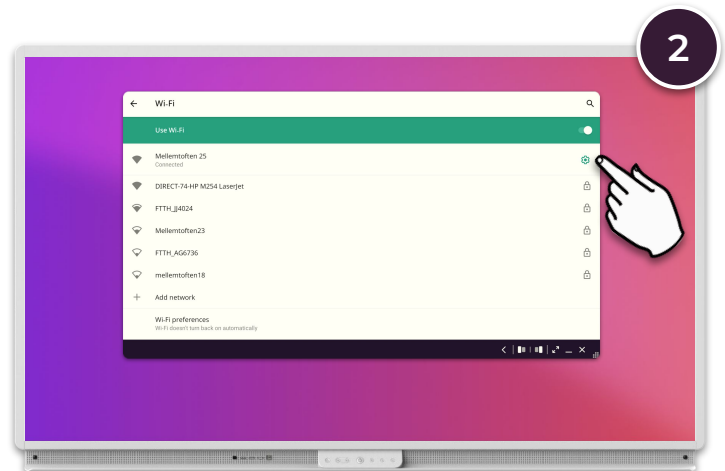

Choose your **network** and click the **Cogwheel** to access more settings.

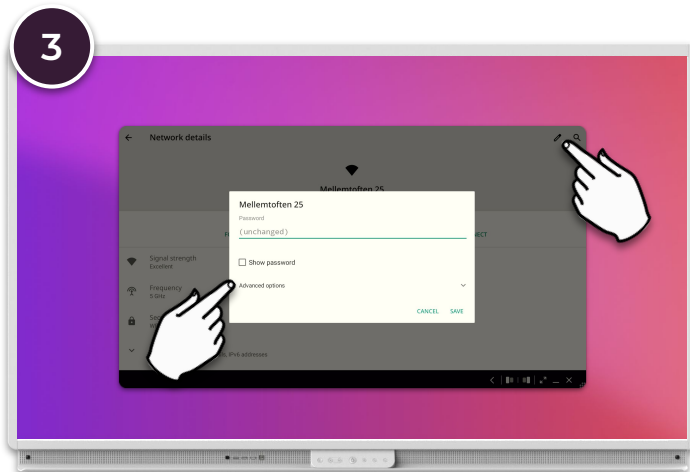

Select the **Pen icon** to edit settings and click **Advanced options**.

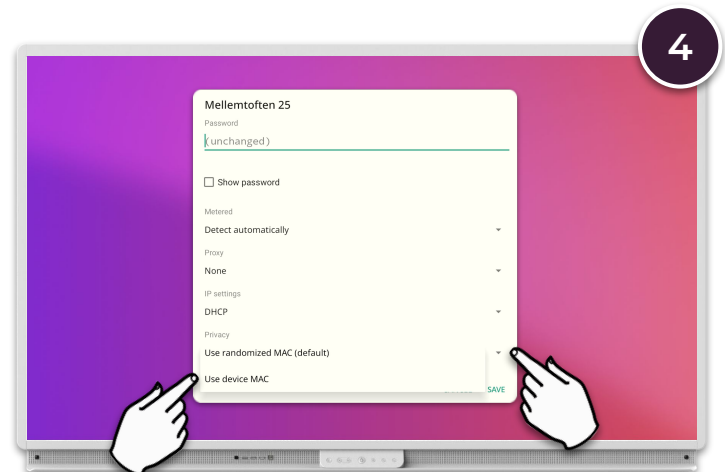

Under **Privacy** click the **dropdown arrow** and select **Use Device MAC**. Then click **Save**.