

How to Use Touchback Within the Promethean Screen Share App on Your ActivPanel Titanium

Promethean users have been asking for Touchback capabilities and we've heard you! The Promethean Screen Share app now allows for Touchback on connected Windows and Mac devices, allowing you to interact with and navigate these devices in real time.

When students connect using Windows or Mac, they will have the opportunity to enable Touchback.

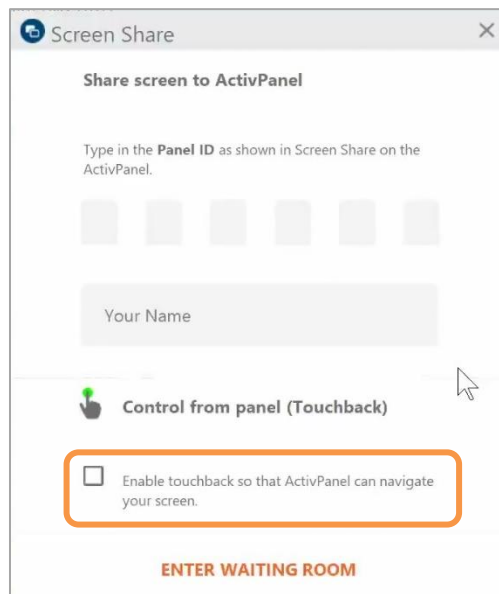

In the Waiting Room, a green dot next to a student's name denotes that they have enabled Touchback.



Promethean®

When a student mirrors their screen with Touchback enabled, their device's screen will be framed in bright green. This is an example of the student's computer screen:



Likewise, when mirroring a student device with Touchback enabled, this screen will also be framed in bright green on your panel, as shown below for the screen in the top left quadrant:

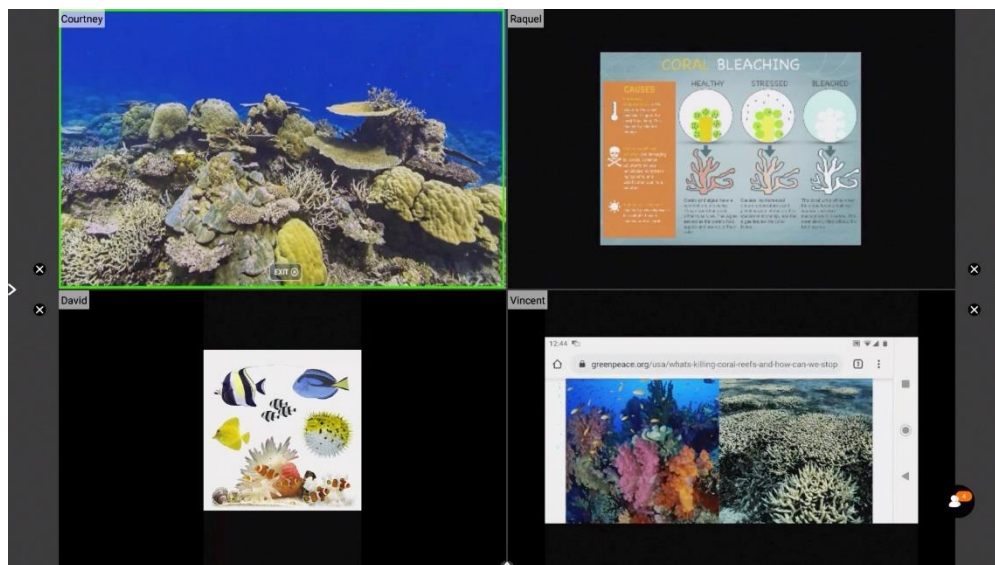

With Touchback enabled, you may navigate connected devices in real time. Possible classroom examples include becoming untethered, sharing applications or programs, allowing students to display work and demonstrate learning, and more.

Follow us on Twitter [@LearnPromethean](#), subscribe to our [Promethean Video](#) YouTube channel, [sign up](#) to hear from us, and [visit our website](#) to learn more.

